

# The 9.7 rated hypothesis..



## Rock Garden

Becca Behrens, Michael Coleman, Mark Dekay,  
Vanessa Gomes Da Silva, Ulrike Passe

# Hypothesis

Our team's hypothesis is that 4 of 5 teammates will experience at least 5 thermal transitions on the walk between the entry and the deck.

# Methodology

In order to test our findings we used HOBO data loggers to record objective data as well as recording our personal sensation of thermal comfort on a series of self-established scales.

Note: We also found thermal spaces not to be congruent with physical spaces, e.g., the thermal sensation of a space extends beyond the threshold.

# HOBO Findings

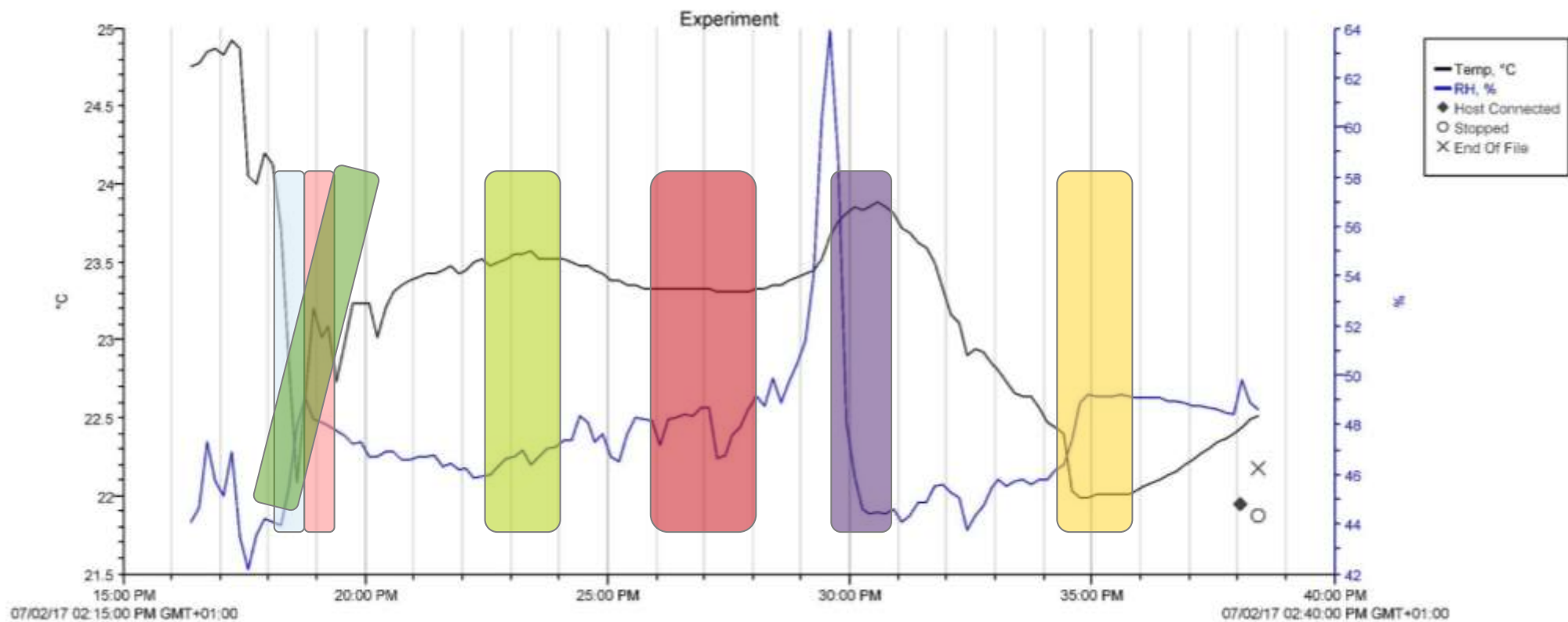

# Human Findings

- ① OUTSIDE ENTRY. •
- ② ENTRY +
- ③ RECEPTION x
- ④ ATRIUM □
- ⑤ TOP OF STAIR ◇
- ⑥ CAFE ★
- ⑦ DECK. ~

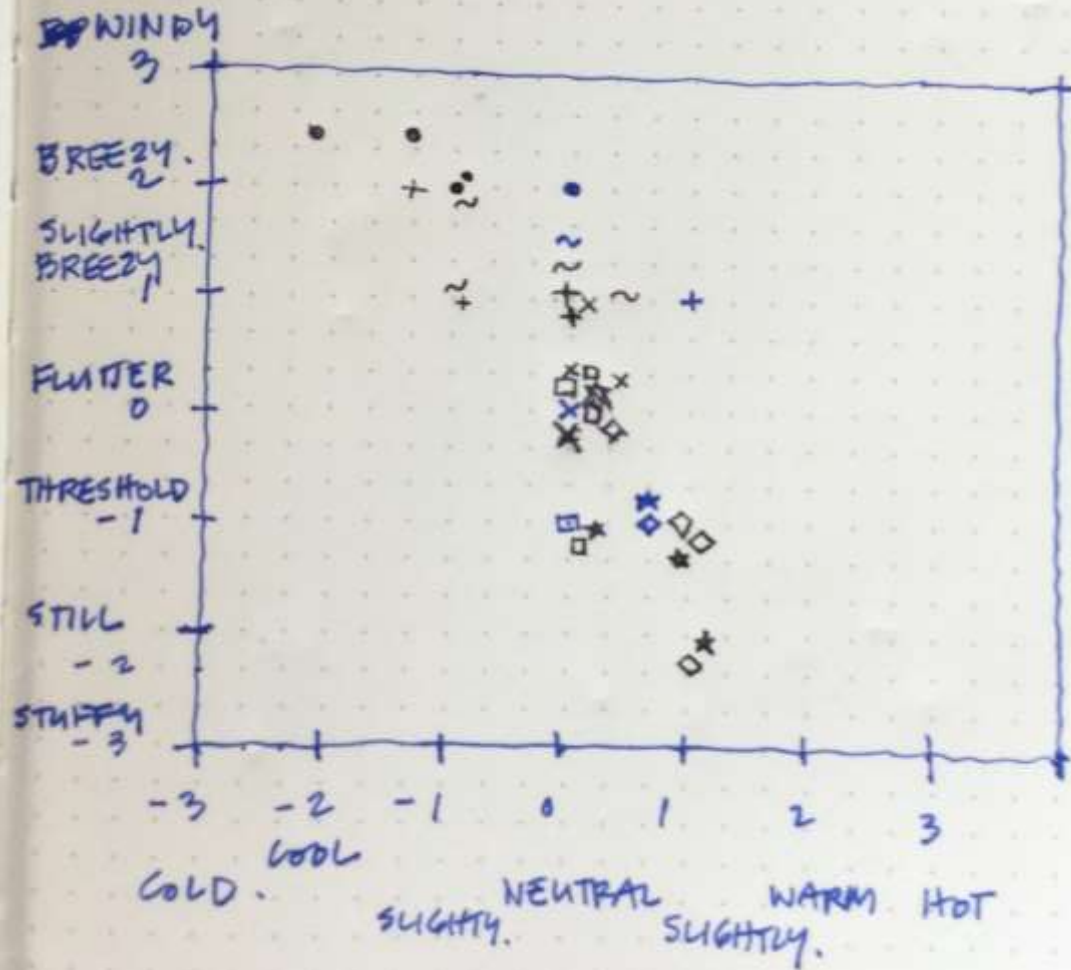

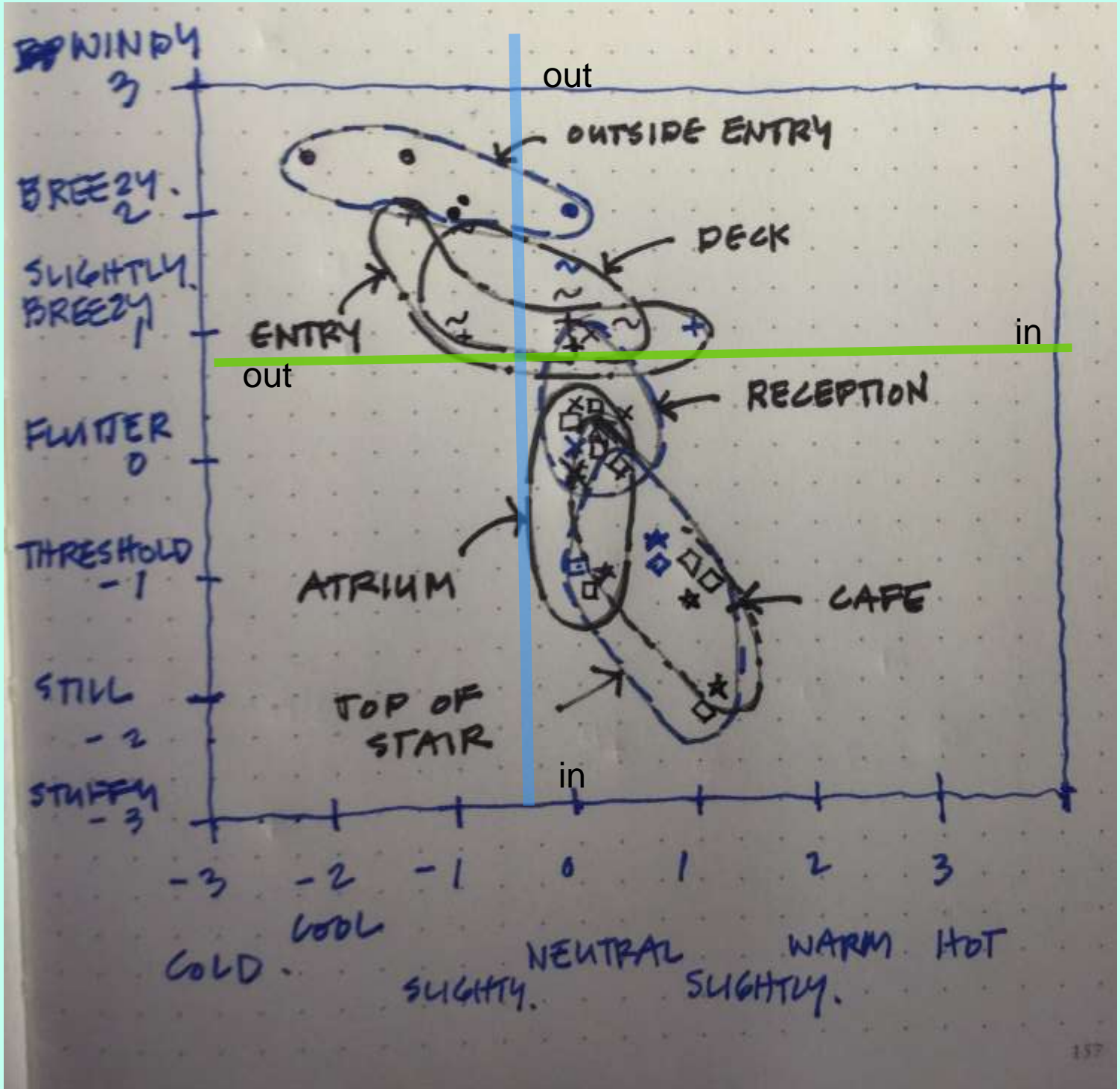

WINDY  
3

BREEZY  
2

SLIGHTLY  
BREEZY  
1

FLUTTER  
0

THRESHOLD  
-1

STILL  
-2

STUFFY  
-3

COLD

COOL

SLIGHTLY

NEUTRAL

SLIGHTLY

WARM

HOT



# Transition Points

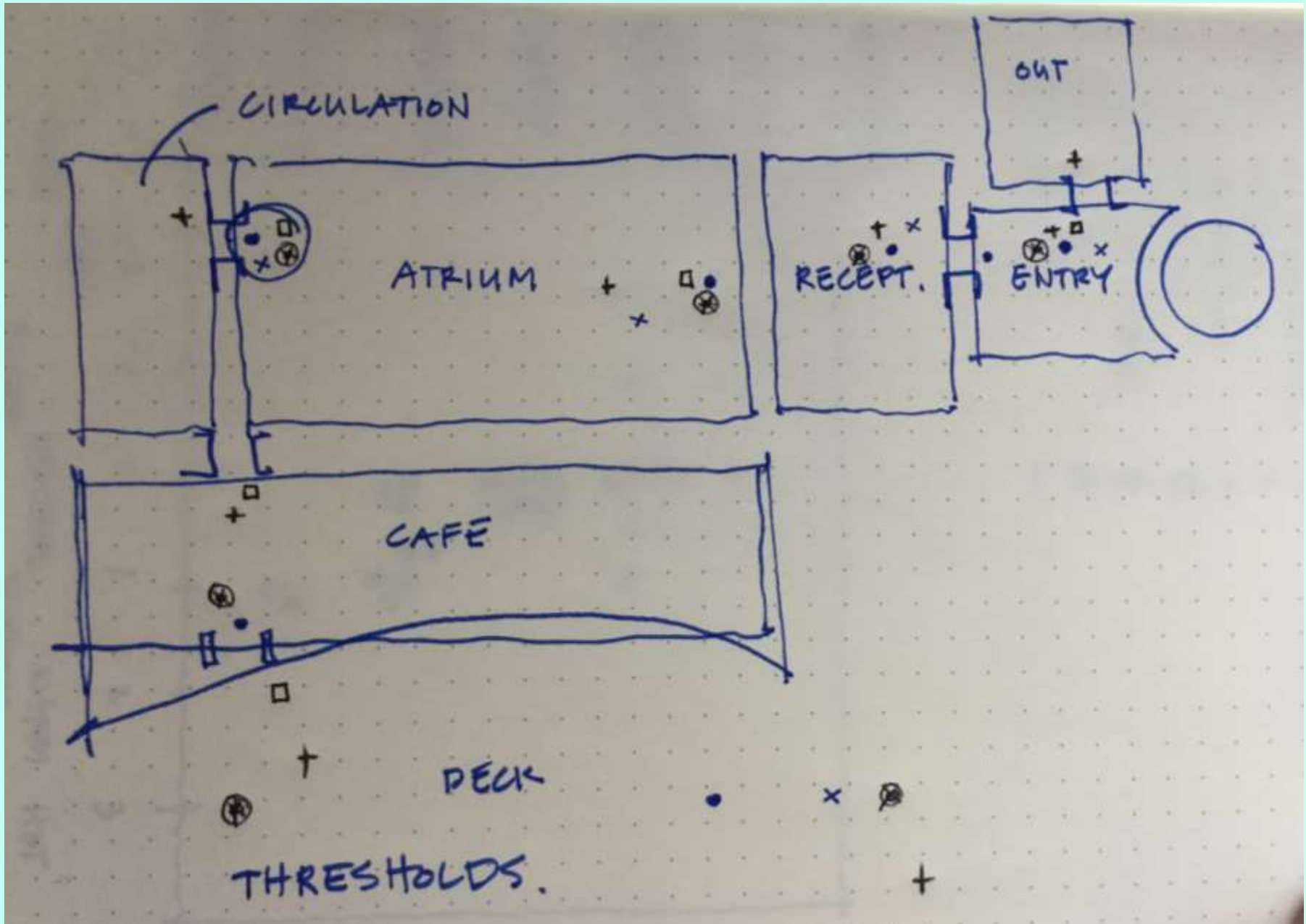

# Conclusions

Our Hypothesis was proven to be correct, because at least 4/5 of our teammates experienced at least 5 thermal transitions. All 5 teammates as well as all the HOBO data were able to back this conclusion.